

# LANGGLIEDRIGE ROLLENKETTEN

DOUBLE PITCH ROLLER CHAINS

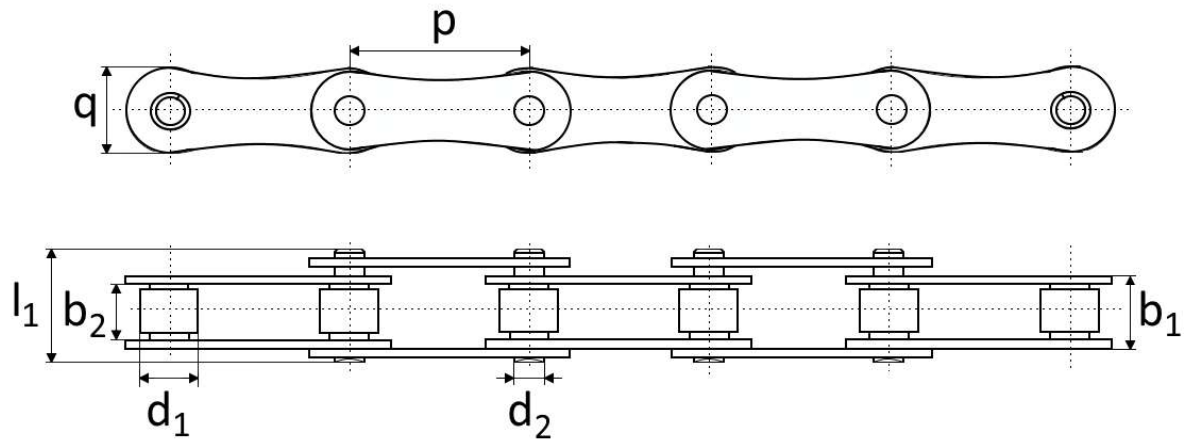

Ketten-Nr. Chain No.	ISO-Nr. ISO No.	p mm	b <sub>1min</sub> mm	b <sub>2max</sub> mm	d <sub>2</sub> mm	d <sub>1max</sub> mm	l <sub>1max</sub> mm	q <sub>max</sub> mm	F <sub>B</sub> N <sub>min</sub>
1091	210 B	31,75	9,65	13,95	5,08	10,16	20	13,6	23 000

Verbindungsglieder sind auf Anfrage erhältlich.  
Connecting links are available upon request.

Verbindungsglied mit Feder  
Connecting link with spring clip

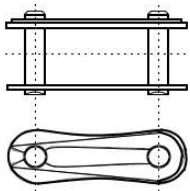

E  
Laufrichtung  
Running direction

Gekröpftes Glied mit Splint  
Cranked link with splint pin

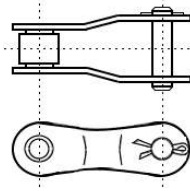

L

Gekröpftes Doppelglied  
Cranked double link

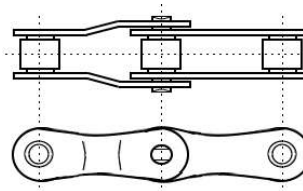

C

Außenglied  
Outside link

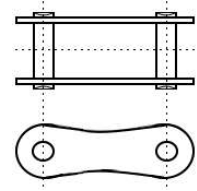

A

Beim Einsatz von gekröpften Gliedern darf nur mit 80% der Bruchkraft gerechnet werden.  
When cranked links are used only 80% of the breaking load may be calculated.

# LANGGLIEDRIGE FÖRDERKETTEN

DOUBLE PITCH CONVEYOR CHAINS

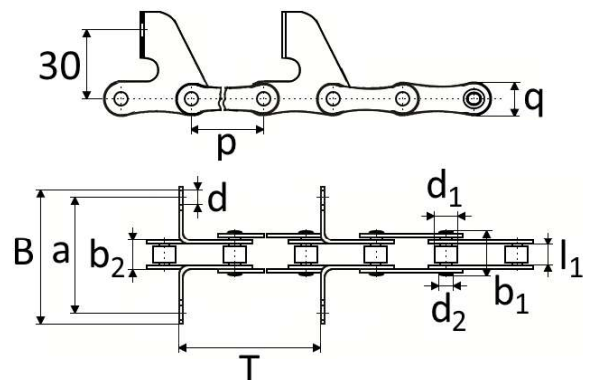
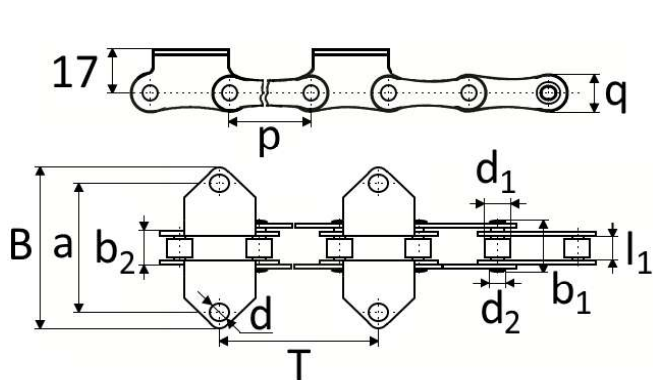

Ketten-Nr. Chain No.	p mm	b <sub>1min</sub> mm	b <sub>2max</sub> mm	B <sub>max</sub> mm	a mm	d mm	d <sub>2min</sub> mm	d <sub>1max</sub> mm	l <sub>1max</sub> mm	q <sub>max</sub> mm	T	F <sub>B</sub> N <sub>min</sub>
1115	31,75	9,65	13,95	72	52	6,6	5,08	10,16	20	13,6	2T; 4T; 6T; 8T; 10T; ...	23 000
1092	31,75	9,65	13,95	72	52	6,6	5,08	10,16	20	13,6	2T; 4T; 6T; 8T; 10T; ...	23 000