

ROLLENKETTEN MIT U-BÜGELN, MIT/OHNE GUMMIPROFIL

ROLLER CHAINS WITH U-SHAPED BRACKET, WITH/WITHOUT MOLDED RUBBER STRIP

Grundwerte Properties	Farbe Colour	Shore Härte Shore hardness A	Betriebstemperaturen Temperature range °C	Beständigkeit Resistance to					
				Antrieb Wear	Einreisse Scratch	Alterungs Ageing	Benzin Petrol	Öl- und Fett Oil and grease	Heisses Wasser- und Dampf Hot water and steam
Styrol Butadien Kautschuk Styrol Butadien Rubber	elfenbeinweiß, hellgrau ivory-white, light grey	70 +/-	-50 / +90	+++	++	++	++	++++	++

++++ ausgezeichnet
 excellent
 +++ sehr gut
 very good
 ++ gut
 good
 + gering
 low
 0 unzureichend
 unsuitable

Rollenketten mit U - Bügeln, mit oder ohne Gummiprofil sind in unterschiedlichen Ausführungen erhältlich. Kundenspezifische Anpassungen können nach Absprache vorgenommen werden.

Roller chains with U-shaped brackets, with or without molded rubber strip are available of different variations. Dimensions may be adjusted as agreed by the customer.

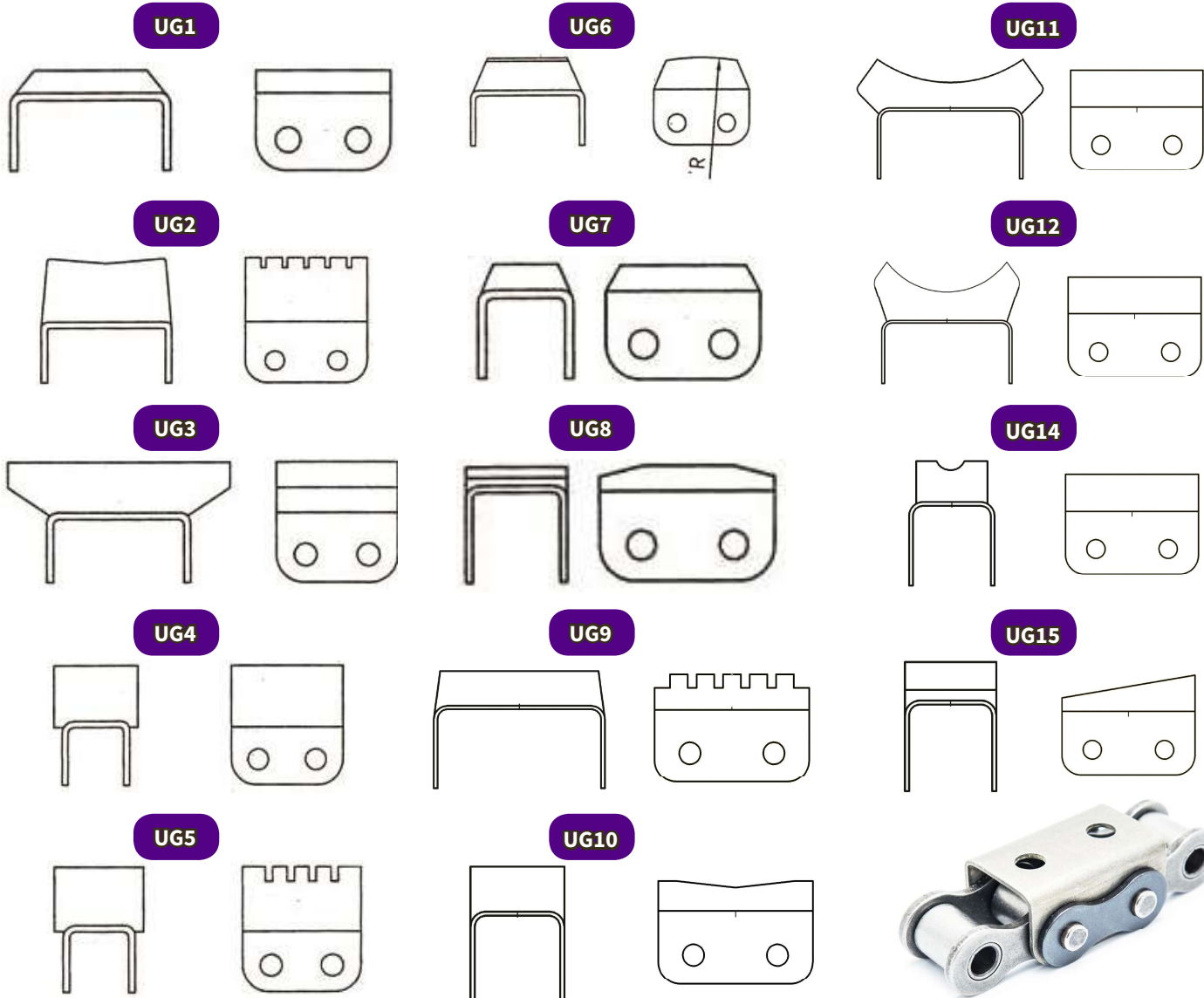
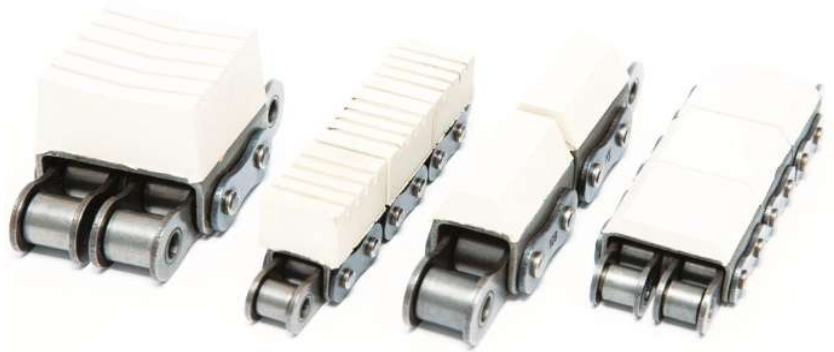

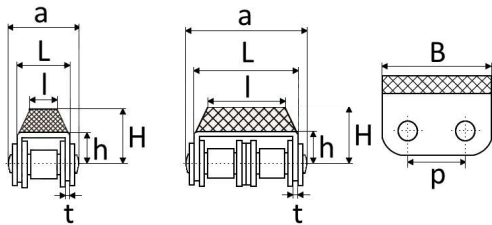

Ketten-Nr. Chain No.	p mm	t mm	l mm	L mm	h mm	H mm	a mm	b mm	F _B N _{min}
08B-1 UG1	12,7	1,3	11,5	14,5	8,3	12,3	19,5	24,32	18 200
08B-2 UG1	12,7	1,3	20	28,4	8,3	12,3	33,5	24,32	32 000
10B-1 UG1	15,875	1,3	11	16,4	10,5	13	21,9	30	23 000
10B-2 UG1	15,875	1,3	29	33	10,5	13	38,9	30	45 400
12B-1 UG1	19,05	1,8	10	19	13	21	25,9	35,6	28 900
12B-2 UG1	19,05	1,8	31	39	12	19,5	45,4	37	57 800
12A-1 UG1	19,05	1,8	19	21,5	13,9	17,9	29,1	35	31 800
16B-1 UG1	25,4	1,8	24,8	30	15,4	21,4	39,3	48	60 000
16B-2 UG1	25,4	1,8	56,8	62	15,4	21,4	70,8	48	106 000
16A-1 UG1	25,4	1,8	21,5	26,7	16,4	22,4	36,1	48	55 600
16A-2 UG1	25,4	1,8	51,3	56,5	16,4	22,4	65,4	48	112 000
20B-1 UG1	31,75	2,4	30	34,8	19	27	46,2	56,15	95 000

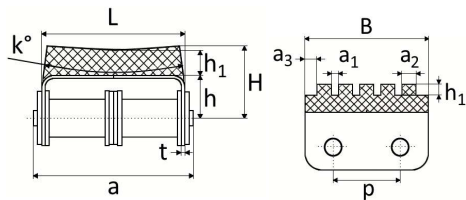

Ketten-Nr. Chain No.	p mm	t mm	k deg	L mm	h mm	h ₁ mm	H mm	a mm	B mm	F _B N _{min}
08B-2 UG21	12,7	1,3	1	28,4	8,3	4,5	16	35,1	24,32	32 000

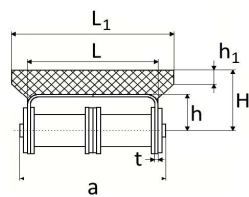

Ketten-Nr. Chain No.	p mm	t mm	L ₁ mm	L mm	h mm	h ₁ mm	H mm	a mm	b mm	F _B N _{min}
08B-2 UG3	12,7	1,3	44	28,4	8,3	5	18,3	33,5	24,32	32 000
10B-2 UG3	15,88	1,3	44	33	10,5	2,5	18,3	38,9	30	45 400

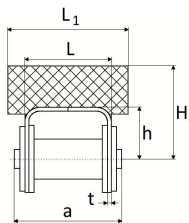

Ketten-Nr. Chain No.	p mm	t mm	L ₁ mm	L mm	h mm	H mm	a mm	B mm	F _B N _{min}
08B-1 UG4	12,7	1,3	18	14,5	8,3	20,3	19,5	24,32	18 200
08B-1 UG42	12,7	1,3	18	14,5	8,3	13,3	19,5	24,32	18 200

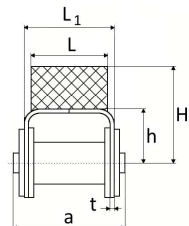

Ketten-Nr. Chain No.	p mm	t mm	L ₁ mm	L mm	h mm	H mm	a mm	B mm	F _B N _{min}
12B-1 UG4	19,05	1,8	18	19,4	13	21	25,9	35,6	28 900
12B-1 UG41	19,05	1,8	18	19,4	13	25	25,9	35,6	28 900

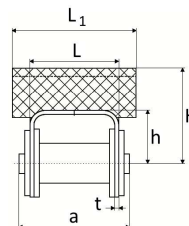

Ketten-Nr. Chain No.	p mm	t mm	L ₁ mm	L mm	h mm	H mm	h ₂ mm	a ₁ mm	a ₂ mm	a mm	B mm	F _B N _{min}
08B-1 UG5	12,7	1,3	18	14,5	8,3	20,3	3	1,5	3	19,5	24,32	18 200
08B-1 UG53	12,7	1,3	18	14,5	8,3	14,3	3	1,5	3	19,5	24,32	18 200

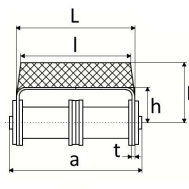

Ketten-Nr. Chain No.	p mm	t mm	l mm	L mm	h mm	H mm	a mm	B mm	b mm	R mm	F _B N _{min}
08B-2 UG6	12,7	1,3	20	28,4	8,3	16,3	33,5	24,32	18	55	32 000

Ketten-Nr. Chain No.	p mm	t mm	k deg	l mm	L mm	h mm	H mm	a mm	B mm	F _B N _{min}
08B-1 UG7	12,7	1,3	30	9,88	14,5	8,3	12,3	19,5	24,32	18 200
08B-2 UG7	12,7	1,3	45	20	28,4	8,3	12,3	33,5	24,32	32 000
08B-2 UG71	12,7	1,3	30	12,7	28,4	8,3	23,3	33,5	24,32	32 000
12B-1 UG7	19,05	1,8	25	14	19,6	13	18	25,9	35,6	28 900
16B-1 UG7	25,4	1,8	30	24,8	30	15,4	21,4	38,7	48	60 000

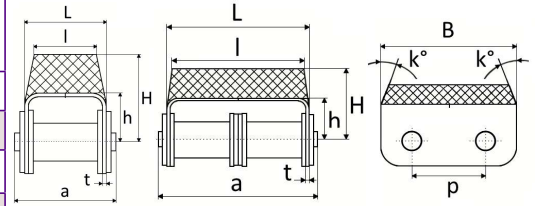

Ketten-Nr. Chain No.	p mm	t mm	L mm	h mm	H mm	c mm	c ₁ mm	a mm	B mm	F _B N _{min}
08B-1 UG8	12,7	1,3	14,5	8,3	12,3	2	5	19,5	24,32	18 200
16B-1 UG8	25,4	1,8	30	15,4	21,4	2,9	11,5	39,3	48	60 000
16B-2 UG8	25,4	1,8	62	15,4	21,4	2,9	11,5	71,4	48	106 000

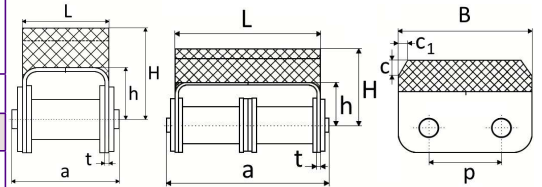

Ketten-Nr. Chain No.	p mm	t mm	k deg	L mm	h mm	h ₁ mm	H mm	a mm	a ₁ mm	a ₂ mm	a ₃ mm	B mm	F _B N _{min}
12B-2 UG9	19,05	1,8	5	39	12	3	28	45,4	1,5	5	3	37	57 800

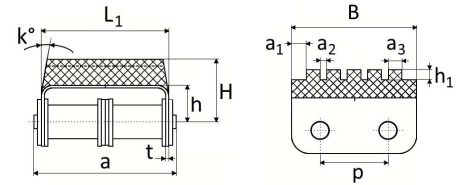

Ketten-Nr. Chain No.	p mm	t mm	L mm	h mm	H mm	h ₁ mm	a ₁ mm	a mm	B mm	F _B N _{min}
16B-1 UG10	25,4	1,8	30	15,4	25,4	3	4	39,3	48	60 000

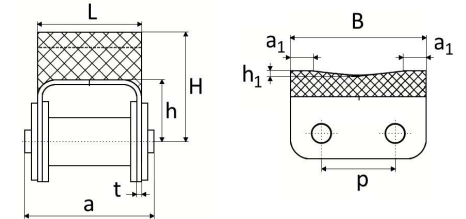

Ketten-Nr. Chain No.	p mm	t mm	L mm	L ₁ mm	L ₂ mm	h mm	h ₁ mm	H mm	R mm	a mm	B mm	F _B N _{min}
08B-2 UG11	12,7	1,3	28,4	39	35	8,3	8	20,8	36	33,5	24,32	31 800

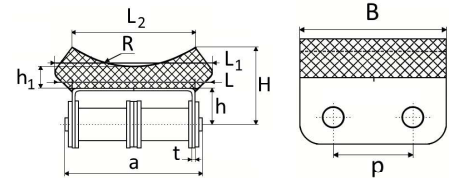

Ketten-Nr. Chain No.	p mm	t mm	k deg	L mm	L ₁ mm	L ₂ mm	h mm	h ₁ mm	H mm	R mm	R ₁ mm	a mm	B mm	F _B N _{min}
08B-2 UG12	12,7	1,3	60	28,4	44	41,5	8,3	8	26,3	27	5	33,5	24,32	31 800

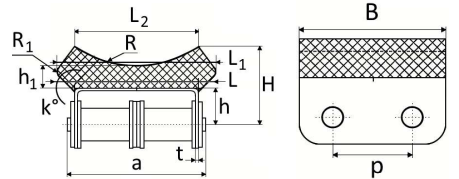

Ketten-Nr. Chain No.	p mm	t mm	R mm	L ₁ mm	L mm	h mm	h ₁ mm	H mm	a mm	B mm	F _B N _{min}
12B-1 UG14	19,05	1,8	3,6	18,4	19,4	13	2,6	23	25,9	35,6	28 900
12B-1 UG141	19,05	1,8	4,76	18,4	19,4	13	3,7	23	25,9	35,6	28 900

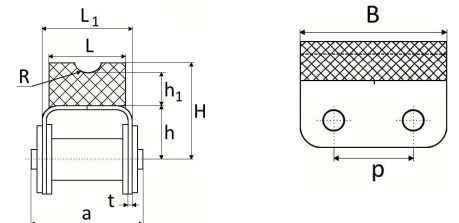

Ketten-Nr. Chain No.	p mm	t mm	k deg	L mm	h mm	H mm	a mm	B mm	F _B N _{min}
16B-1 UG15	25,4	1,8	15	30	15,4	32,9	39,3	48	60 000

